

HOME HOTEL

JEAN-MARIE MASSAUD (2018)



DESCRIPTION

Containers with a variable geometry and refined details. Originality expressed in primary shapes that blend contrasting materials and colours. Furnishings projected into the modern age for a contemporary vision of the most classic open storage units.

Poliform

HOME HOTEL

JEAN-MARIE MASSAUD (2018)



TECHNICAL DESCRIPTION

Typology

Sideboards

Structure

Panel of wooden particles in veneer

Drawer structure

Medium-density fibre panel melamine

Door / Drawer front:

Honeycomb lacquer panel with frame in wood

Base

Solid wood

Note

Inner structure only available matt lacquer in the same colour of the front

HOME HOTEL

JEAN-MARIE MASSAUD (2018)

MHH02

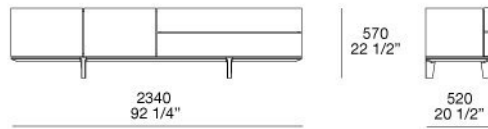

MHH03

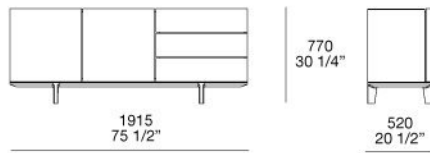

MHH04

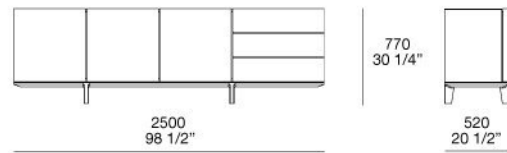

MHH05

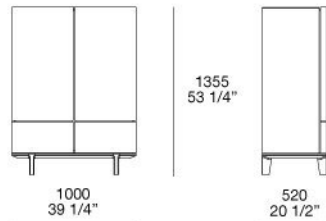

HOME HOTEL

FINISHINGS\STRUCTURE - BASE - FRAME\WOODS (2)

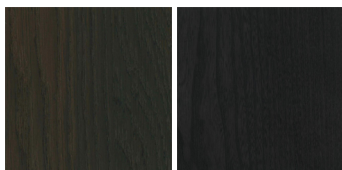

SPESSART
OAK

BLACK ELM

HOME HOTEL

FINISHINGS\FRONT\MAT LACQUERED COLOURS (27)



77
CHAMPAGNE

35 CANAPA

26 CORDA

88 CASTORO

64 ARENA

46 TORTORA

48 VISONE

49 MOKA

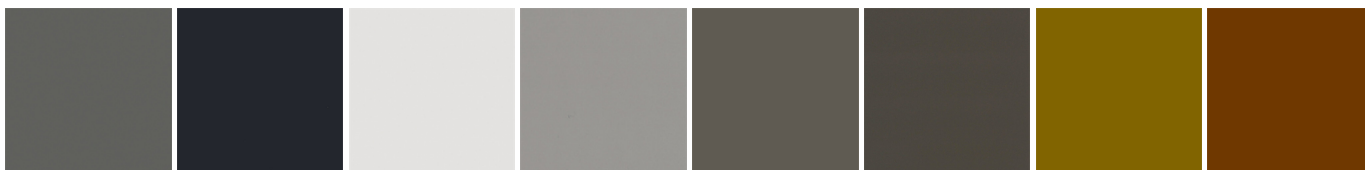

78 FERRO

04 GRAFITE

60 GHIACCIO

09 PIOGGIA

89 ROCCIA

90 PIOMBO

83 OCRA

85
CARMELLO



87 GRANATA

92 VISCHIO

67 MUSCHIO

86 DANUBIO

70 PRUSSIA

82 GLACIER-
WHITE

01 BIANCO

91 CARBONE



23 BRONZO

24 OTTONE

02 ARDESIA

HOME HOTEL

FINISHINGS\FRONT\METAL LACQUERED (4)



25 TITANIO

24 OTTONE

23 BRONZO

02 RAME