

# BANGKOK

OPERADESIGN (2006)



## DESCRIPTION

An exclusive and elegant wardrobe designed by Operadesign. A piece of furniture always unique like you.

**Poliform**

# BANGKOK

OPERADESIGN (2006)



## TECHNICAL DESCRIPTION

### TYOLOGY

doors Senzafine collection

### OPENING

leaf door and coplanar door

### DOOR FINISHING

covered in hide

### PROFILE FINISHING

chromed metal, piombo mat lacquered, mat painted brown nickel and glossy painted brown nickel

### HANDLE

integrated on the orizontal profile

### NOTE

no reduction possible, Ego doors cannot be leant next to it

# BANGKOK

OPERADESIGN (2006)

## DIMENSIONS

senzafine wardrobes

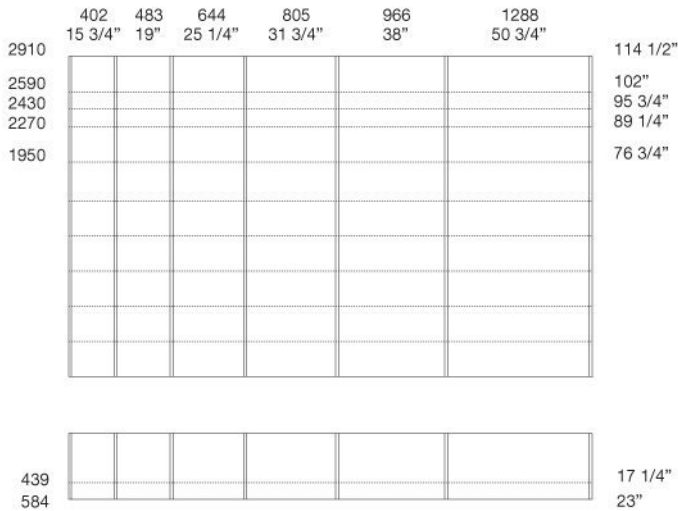

Size calculation with side thickness 25 - 1"

To obtain the total width, add to the sum of the columns mm 25 - 1" for the lateral side.

## BANGKOK *design Operadesign*

senzafine doors collection

unit widths

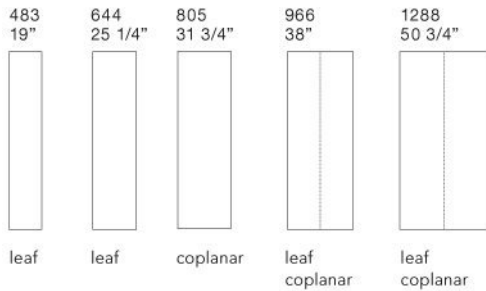

unit heights

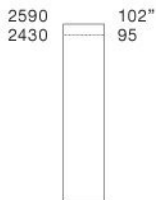

handles positioning

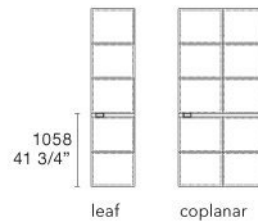

Door section

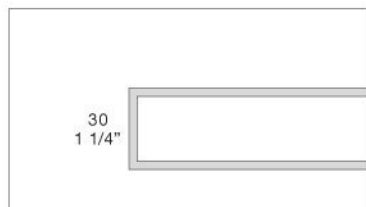

leaf and coplanar door

**NB**

No reductions possible.  
Ego doors cannot be leant next to it.

# Poliform

# BANGKOK

FINISHINGS\DOORS\HIDE (8)

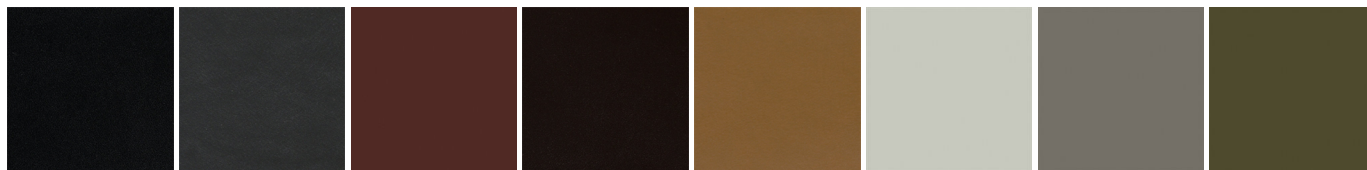

2 NERO

3 GRIGIO  
SCURO

15 PRUGNA

19 CAFFÉ

26  
INVECCHIAT  
O

28 AVORIO

29 TORTORA

38 OLIVA

# BANGKOK

FINISHINGS\STRUCTURE\SENZAFINE MELAMINE (6)

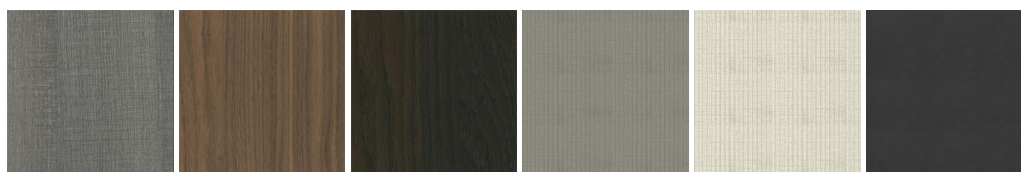

MELAMINE  
CENERO OAK

MELAMINE C.  
WALNUT

MELAMINE  
SPESSART  
OAK

MELAMINE  
CANVAS  
GRIGIO

MELAMINE  
CANVAS  
BEIGE

MELAMINE  
ARDESIA

# BANGKOK

FINISHINGS\PROFILES\CHROMED METAL (1)

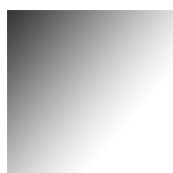

CHROMED  
METAL

# BANGKOK

FINISHINGS\PROFILES\ BROWN NICKEL MAT PAINTED (1)

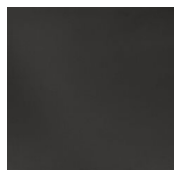

BROWN  
NICKEL MAT  
PAINTED

# BANGKOK

FINISHINGS\PROFILES\GLOSSY PAINTEDBROWN NICKEL (1)



GLOSSY  
PAINTEDBRO  
WN NICKEL

# BANGKOK

FINISHINGS\PROFILES\ PIOMBO MAT PAINTED (1)

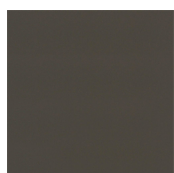

PIOMBO

# BANGKOK

FINISHINGS\METAL PARTS\METAL PARTS (2)



MATT  
CHAMPAGNE

MATT  
ARDESIA